



## 1100 N. Garland 2.2 acre tract Pheasant Run Golf Community Enid, OK

Call for pricing

Situated on the corner of Blue Stem and N. Garland (approx. 1100 block; N. side of Blue Stem) in Enid, OK, this desirable C-2 Planned Business Center, 2.2 acre tract, is surrounded by the exclusive Pheasant Run Golf Community and golf course. All the public utilities are there, as well as a variety of preferred roof tops, with A+ multifamily to \$1M+ single family homes. Call Jay Nicholas 580-234-7200 for more information, and to join this premier neighborhood. We also have a 2.3 acre tract on the South side of Blue Stem, and would consider selling both parcels at a discount. Broker/Owner.



### Details

**Zoning** C-2 Planned Business Center

**Lot Size** 95,970 sq. ft. approximately

#### HVAC

**Utilities** All public, available.

#### Bathrooms

#### Offices

#### Office Areas

#### Parking

#### Shop/Warehouse

#### Common Areas

**Location (City)** Enid

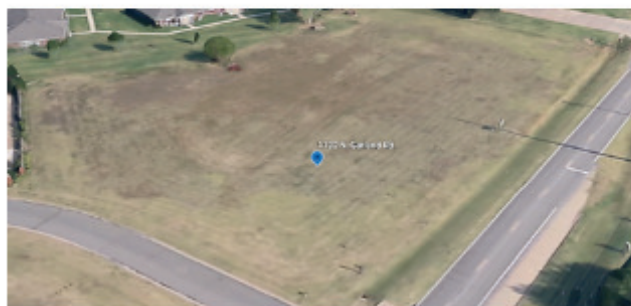
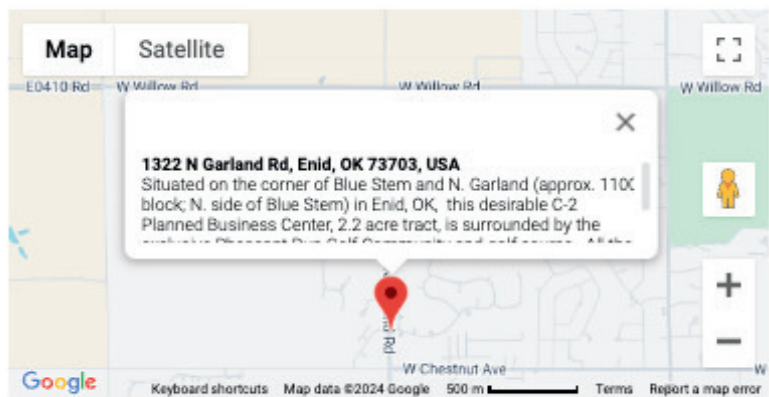

### Agent



**Jay Nicholas**

**580-234-7200**

**Jay@Nicholascommercial.com**